

LFX Master dim



Specs

General

<i>output channels</i>	one
<i>operation voltage</i>	autosense 100-240 VAC 50/60 Hz
<i>temperature range</i>	-20°C...40°C (-4°F... 104°F)
<i>dimensions</i>	170 x 125 x 125 mm
<i>weight</i>	1.75 kg (3.9 lbs)
<i>max. output power</i>	10 Amps @ 230VAC 50 or 60 Hz: 2.3 kW @ 110VAC 50 or 60 Hz; 1.1 kW

HD effect presets

fire, candle, TV, strobe

<i>resolution preset</i>	24 fps on default value
<i>transitions</i>	shapes edges of a curve hard, medium or soft

Strobe t= 67.5 msec ...28 secs, aspect ratio 50%

We are designing flicker boxes since more than 20 years based on our experience on location & passion for electronic engineering.



Watch sample film clips on our website of each effect & find detailed information.



movie-intercom
Bluecherstr. 21
10961 Berlin
Germany
call +49 30 2232 0575
info@movie-inter.com

www.movie-inter.com

LFX Master DMX



Specs

General

<i>output channels</i>	three
<i>operation voltage</i>	6 - 32 VDC, 200 mA, PSU included
<i>temperature range</i>	-10...65°C (14°F... 149°F)
<i>dimensions</i>	200 x 110 x 86 mm
<i>weight</i>	650 grams (1.4 lbs) w/o PSU
<i>DMX sockets</i>	5-pin XLR
<i>DMX protocol</i>	USITT DMX-512-A

HD effect presets

fire, candle, TV, welding, „broken“ fluoro, strobe

<i>resolution preset</i>	24 fps on default value
<i>transitions</i>	shapes edges of a curve hard, medium or smooth

Device presets for DMX output

Pre-defined DMX set-up

- for **Kino Flo**: Freestyle LED, Select LED, Diva-Lite LED, Celeb LED, Parabeam, Parazip
Modes available: White, Gels/Hue, RGB
- for **Arri**: SkyPanel, L5-C, L7-C, L10-C, Broadcaster 2+
Modes available: CCT, Gel, RGBW
- generic 2-channel LED device
- 12-channel tungsten dimmer
- custom DMX channel configuration for all others

DMX input presets

- Separate dim (max & min) control for CH 1, 2, 3
- remote control via DMX
- arbitrary allocation of DMX patches or functions

Use the LFX Master DMX as an inline device in an existing DMX universe.

all specs subject to change without prior notice, v2017-8



The Best Flicker Boxes

Natural looking
lighting effects of
Fire, TV, welding & more

LFX Master dim

Universal Flicker Box

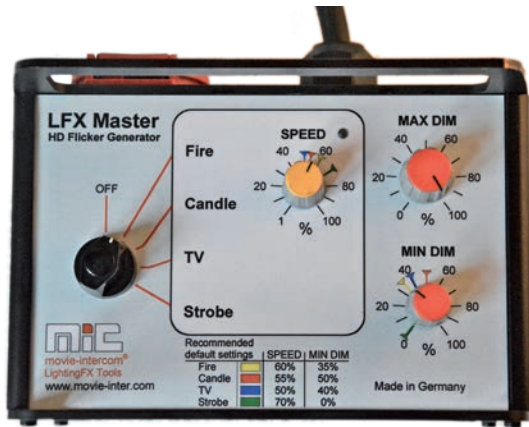

Fire - Candle - TV - Strobe

The most easy way to create natural looking lighting effects.

Plug & play on any mains power (100 – 240 VAC) for worldwide operation.

- HD flicker curves
- autosensing 100 - 240 VAC 50 & 60 Hz
- built-in 10 Amp dimmer

It's fun to create LFX - with the **LFX Master dim**.

* requires DMX dimmer pack

LFX Master DMX

Most Versatile

Create the highest quality of lighting effects with multiple LED fixtures, fluoros and tungsten*.

Three channels are perfect for fire with flickering shadows or TV-RGB effects.

Device presets allow for quick set-up of the DMX-512 communication.

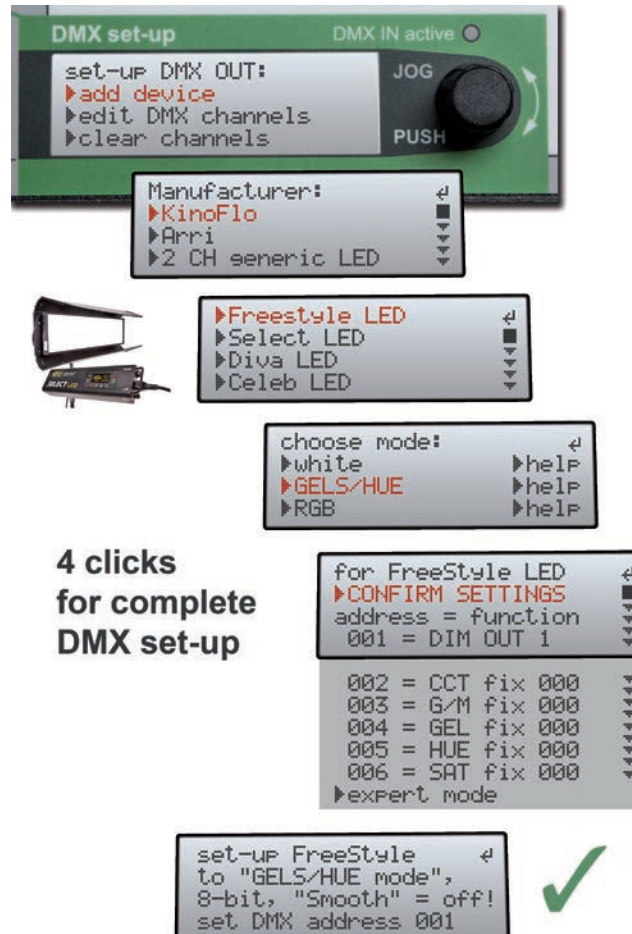

Most Powerful Flicker Box



Fire - Candle - TV - Welding - „broken“ Fluoro - Strobe

- HD flicker curves
- DMX-512 OUT & IN
- LED fixture presets
- three output channels
- arbitrary DMX patching
- DMX input presets
- remote control via DMX
- battery operation
- iPad remote control

It's fun to create LFX - with the **LFX Master DMX**.

www.movie-inter.com